

**SERVICE MANUAL**  
**AND**  
**PARTS CATALOG**  
**FOR YOUR**  
**SUPER 29D**



*Grain, Seed and Bean Cleaners*

# SUPER 29D WITH BRUSHES

UPDATED APRIL 26, 2021

## TOP FAN ASSEMBLY

ITEM NO.	PAGE NO.	PART NUMBER	QTY.	DESCRIPTION
3		F01101802	1	3/4" Back Damper Flange Bearing
5	3	F01604400	1	1-15/16" X 65" Top Fan Shaft
		Not Available		Old Style A Frame Housing
10	3	F92400024	2	1-15/16" Bearing Insert <b>(For Above A Frame Housing)</b>
11	2	F04303136	1	Adjusting handle & Crank (36" Long for back air)
4	1	F05313000	2	Adjusting handle shaft Bearing
	1	F04001600	1	Hand Crank Handle with wood Knob
16	2	F05002200	1	Back Air Damper with End Castings
17	1	F05002200	1	Front Air Damper with End Castings
	1	F01013500	2	Valve Control Assy Complete <b>See Attached Picture</b>
18	3	F05502300	2	High Static Fan Wheel Assembly with 6" Wide Blade
215	26	F05501201	1	Right Side Top Fan Housing Assembly ( <b>Includes 2 Sides &amp; Metal</b> )
215	26	F05501204	1	Left Side Top Fan Housing Assembly( <b>Includes 2 Sides &amp; Metal</b> )
15	1	F05003900	2	Top Fan Bleeder Inlet Slide Assembly

**\*\*Refers to the previous listing number. May give parts within that assembly, right side-left side numbers, or numbers for parts that are specific to RH or LH machines.**

**Note: Front of the Machine is Where the Screens are Inserted Into the Machine. Discharge Spouts are Determined by Standing at the Front and Facing the Machine. Right Hand Discharge Spouts Would Discharge Towards Your Right Hand.**

## TOP AIR DISCHARGE ASSEMBLY

ITEM NO.	PAGE NO.	PART NUMBER	QTY.	DESCRIPTION
21	All 4	F04500000	1	Complete Valve Assembly <b>(Includes Below)</b>
22	4	F04800010	1	Hinged Gate Weldment, 25-7/8"
**		F04600510	1	Gate Board 2.5" x 31.25"
**		F92700004	2	Gate Springs
23	4	F04501401	1	#9 Discharge Roll Assembly with Flanges (Wood Is 25-7/8")
		F01100000	2	5-1/4" Cast Flange Bearing 1" Bore
<b>Note: if new unit is built, the bearings below will be used</b>				
25	4	40000038	4	1" Bore Flangette Stampings <b>(New Style)</b>
186	4	F92460200	2	1" Bearing <b>(New Style)</b>
	2	F11303814	2	Bearing Standoff Bracket
20	4	F01614500	1	Top Valve Shaft 1" X 44-1/2"

## BRUSH ADJUSTING SYSTEM

ITEM NO.	PAGE NO.	PART NUMBER	QTY.	DESCRIPTION
42	7	F01000900	4	Adjustments Handle with Spring (about 6" long)
		F01200203	8	Pionion Gear 3/4" Bore
		F01000200	12	Rope Sheave Assembly Complete <b>See Attached Picture</b>
41	9	F01104300	4	One Hole Plate with 1-5/8" Bore
51	9	Not Available	2	Straight Jack Plate
**	9	Not Available	1	Right Hand Beveled Jack Plate
**	9	Not Available	1	Left Hand Beveled Jack Plate
		F97700003	65	Wirelon Plastic Coated Cable (In Feet)
48	10	F01605805	4	Brush Carrier Shaft 1" X 52-5/8" <b>(Machined down to 3/4" on ends)</b>
	10	F10002120	8	49-1/2" Black Course Brushes
	10	F10002110	8	49-1/2" White Fine Brushes <b>(Used on Wire Mesh Screens)</b>
54	10	F09500200	4	NEW STYLE Brush Carrier Assy 18" with Rollers (Brushes not included) <b>See Attached Picture</b>

## BOTTOM FAN ASSEMBLY

ITEM NO.	PAGE NO.	PART NUMBER	QTY.	DESCRIPTION
		F01612420	1	Fan Shaft 1-1/2" X 74-1/2" (Includes Keys) <b>See Attached Pictures 11 &amp; 12</b>
		Not Available	2	6715 Bridgetree Housing
		F92400022	2	Bearing Insert Only For Above
		F97700052	2	Tapered Fan Entry Cones
201	25 A	F06302020	1	Bottom Drum Iron 45-5/8" x 80"
203	25 A	F06302120	1	Discharge Chute 45-5/8" x 4"
204	25 A	F06304303	1	Breast Iron 45-5/8" x 27-1/4"



## COUNTERSHAFT ASSEMBLY

ITEM NO.	PAGE NO.	PART NUMBER	QTY.	DESCRIPTION
73	14	F01612800	1	Countershaft 1-1/2" X 70-3/4" ( Includes Keys) See Attached Pictures 13 & 14
		Not Available	1	6714 Halfmoon Housing
		F92400022	1	Bearing Insert Only For Above
		F92053126	1	6714 Conversion Kit Complete with Bearing
		F92053126	1	6714 Conversion Kit Complete with Bearing

## ECCENTRIC SHAFT ASSEMBLY

ITEM NO.	PAGE NO.	PART NUMBER	QTY.	DESCRIPTION
		F01615010	1	Eccentric Shaft 1-1/2" X 66-1/2" (Includes Keys) See Attached Pictures 15, 15B & 16

**NOTE: SOME OLDER MACHINES USED AN ECCENTRIC SHAFT THAT WAS 62-1/2" (F01612500) LONG BUT THE ABOVE SHAFT CAN BE USED**

## MISCELLANEOUS PARTS

ITEM NO.	PAGE NO.	PART NUMBER	QTY.	DESCRIPTION
182	18	F08000000	2	Hinged Side Spout Diverter
183	23	F08501276	1	Front Inside Catchall Spout with 7-1/2" Lip, Left Hand Discharge
183	23	F08501275	1	Front Inside Catchall Spout with 7-1/2" Lip, Right Hand Discharge
184	23	F08501277	1	Front Outside Catchall Spout with 9-1/2" Lip, Right Hand Discharge
184	23	F08501278	1	Front Outside Catchall Spout with 9-1/2" Lip, Left Hand Discharge
181	23	F01800100	2	Right Side 3 Position Catchall Holder
**	23	F01800200	2	Left Side 3 Position Catchall Holder
193	All 24	F01002803	1	Belt Idler Assembly Complete 5-1/2" <b>(Includes Below)</b>
178	24	F01100100	1	Idler Pivot Lever
191	24	F01806202	1	5-1/2" Belt Take Up Shaft
179	24	F01103300	1	1" Cast Iron Pillow Block
180	24	F01400700	1	Idler Sheave with Bushing
185	24	F01805010	1	Belt Tightner Axle with Hardware

## PULLEYS & BELTS

ITEM NO.	PAGE NO.	PART NUMBER	QTY.	DESCRIPTION
167		F91162112	1	B-112 Belt (to Brush Drive)
		F01303510	1	3-4 Combination Pulley 1-1/2" Bore
		F91162096	1	B-96 Belt (to Top Air Discharge)
170		F91912080	1	1B8.0 SDS Valve Shaft Sheave ( Is Driven by Eccentric Shaft)
**		44010510	1	SDS Bushing for Valve Shaft Sheave
174		<b>Obsolete</b>	1	1B 3.0 Countershaft Pulley 1-1/2 Bore" (Drives Hopper)
167		F91162112	1	B-112 Belt ( to Hopper)
172		43120255	1	2B12.4 SK Countershaft Sheave (Is Driven By Top Fan Shaft)
**		44010918	1	SK Bushing for above
173		43120115	1	2B5.4 SDS Top Fan Shaft Pulley (Drives Countershaft)
**		44010525	1	Bushing SDS 1-15/16" for above
166		F91162120	2	B-120 Belt (From Countershaft to Top Fan)

**Note: The Original Drive From the Top Fan to the Countershaft was a 3 Groove Fixed Bore Pulley. Change this to a 2 Groove Pulley and Bushing**

**The Following Are the Ball Tray Kit Parts That were  
Installed on the Super 29D Cleaners in the Past**

Old Style Ball Trays with 1" Square Turkey Wire That Came Out  
With the Screens. Ball Trays were not attached to the Screens.

F90005062	4	Ball Tray Weldment for 1 Piece Screens
F80026101	432	Black 1-3/8" Balls ( 108 Per Tray)
		or
F90005063	4	Ball Tray Weldment for 2 Piece Screens (For Bottom 26" Section)
F90005069	4	Ball Tray Weldment for 2 Piece Screens (For Top 34" Section)
F80026101	432	Black 1-3/8" Balls ( 54 Per Tray)
F11301707	8	Ball Tray Support Rail 24"
F11301708	8	Ball Tray Support Rail 31"
F90005101	2	Rocker Adjusting Girt Assembly Center
F90005301	2	Rocker Adjusting Girt Assembly Offset

**New Style Permanent** Ball Trays with That Stayed in the Machine  
When the Screens Were Removed. Became available in 1994

F92053515		Ball Tray Kit Complete ( <b>Includes Below</b> )
F90008272	8	Permanent Ball Tray Weldment
F80026101	640	Black 1-3/8" Balls ( 80 Per Tray)
F11308889	4	Right Hand Ball Tray Rail w/ End Stop
F11308890	4	Left Hand Ball Tray Rail w/ End Stop
F90008258	4	Right Hand Ball Tray Rail w/ Screen Hook Holder Bracket
F90008259	4	Left Hand Ball Tray Rail w/ Screen Hook Holder Bracket
F03500800	8	Screens Hook Assembly Screws and Bolts

BLUE PRINT SUPPLY COMPANY, INC.

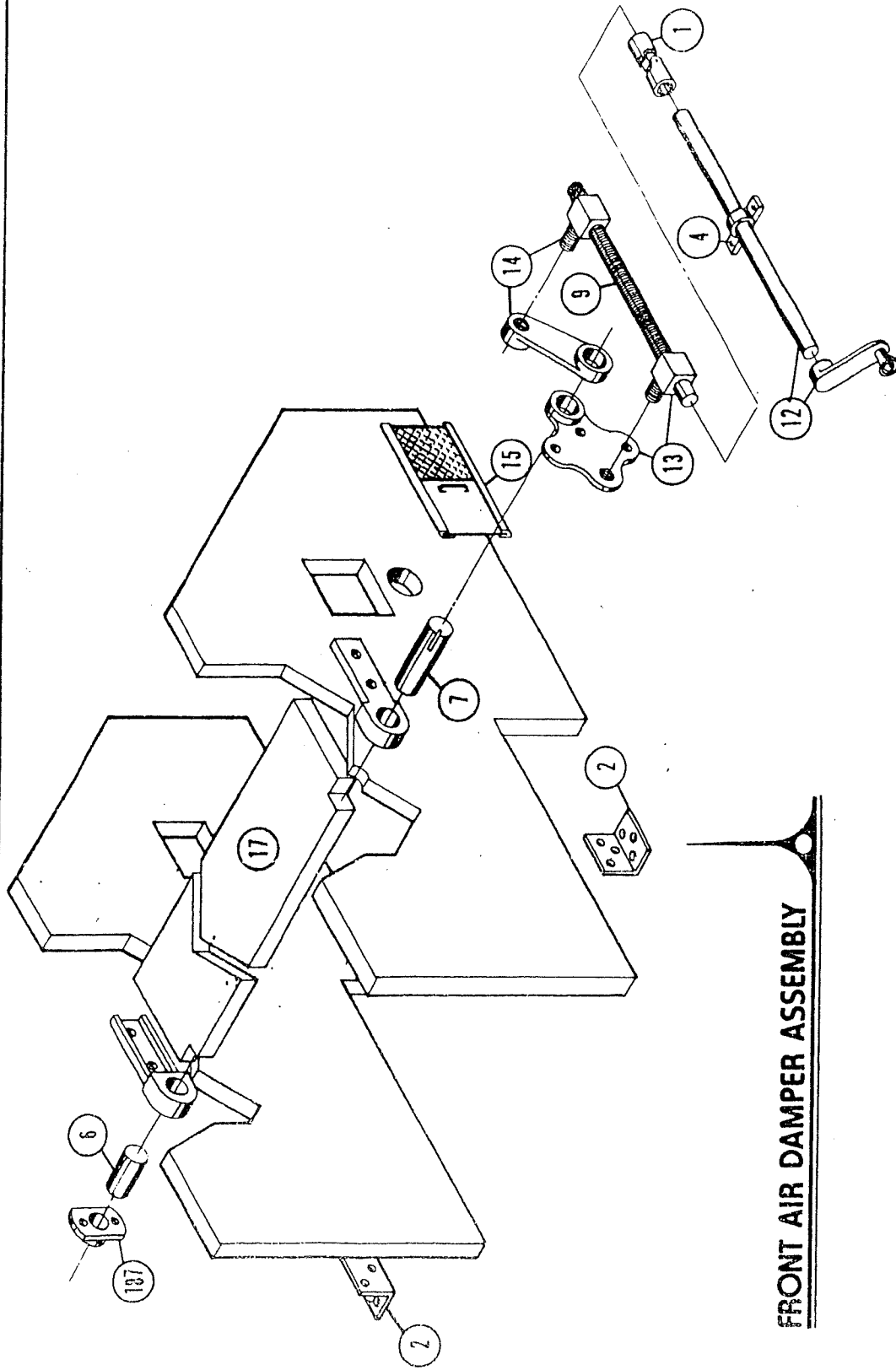

# FRONT AIR DAMPER ASSEMBLY

SYN		REVISION		DATE		OR		DATE		DWG NO		MACH NO	
front air damper assembly										DWG NO		MACH NO	
FERRELL - ROSS SAGINAW, MICH.										DWG NO		MACH NO	
DATE										SCALE		DATE	





ALL VIEWS DRAWN TO SCALE UNLESS OTHERWISE NOTED

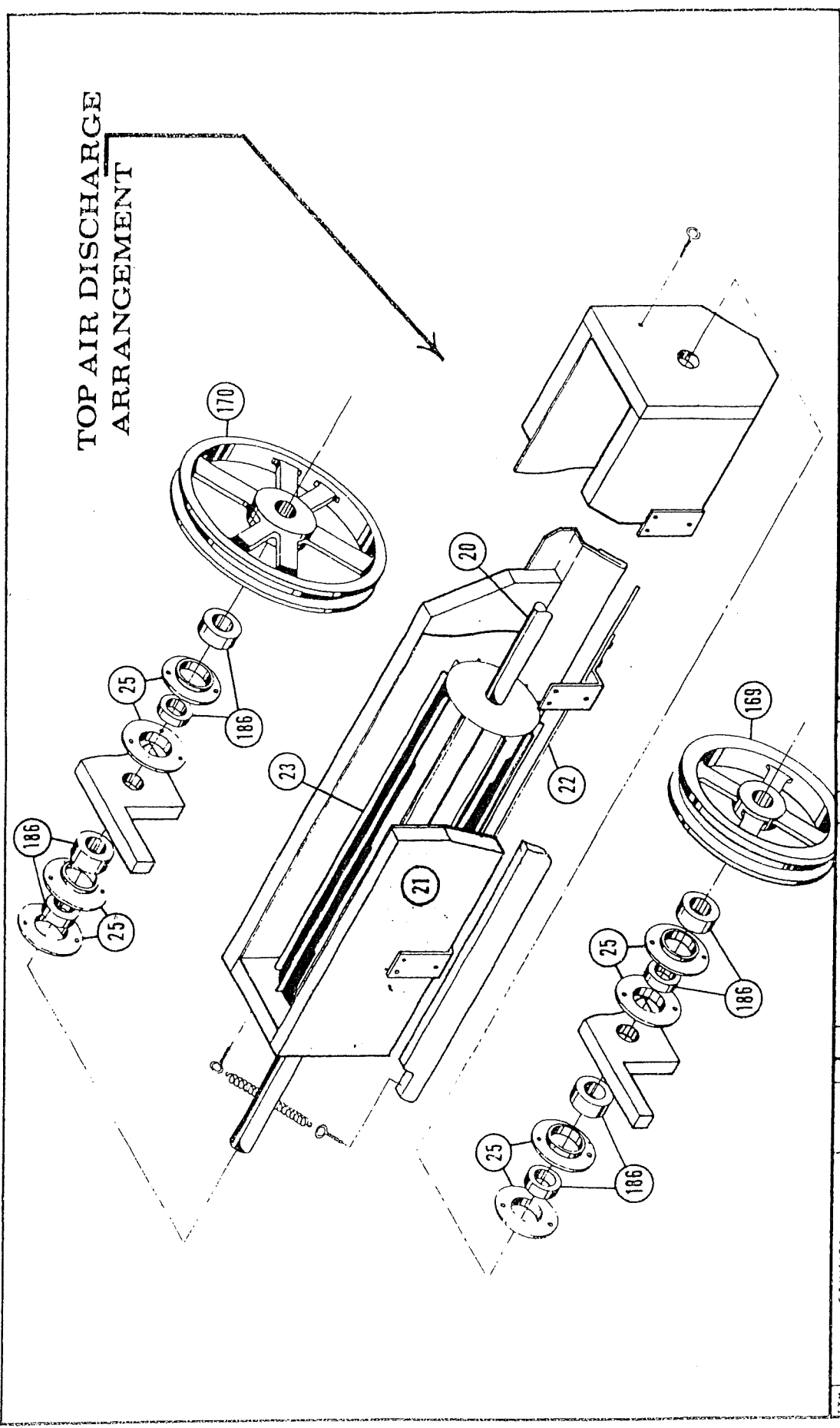

SYMBOL	REVISION	DATE	BY	DATE	SCALE	DATE	DWG NO.
						12-30-77	
- top air discharge arrangement							
FERRELL - ROSS							MACH NO
SAGINAW, MICH.							

BLVD. PAPER SUPPLY CO. INC. DETROIT

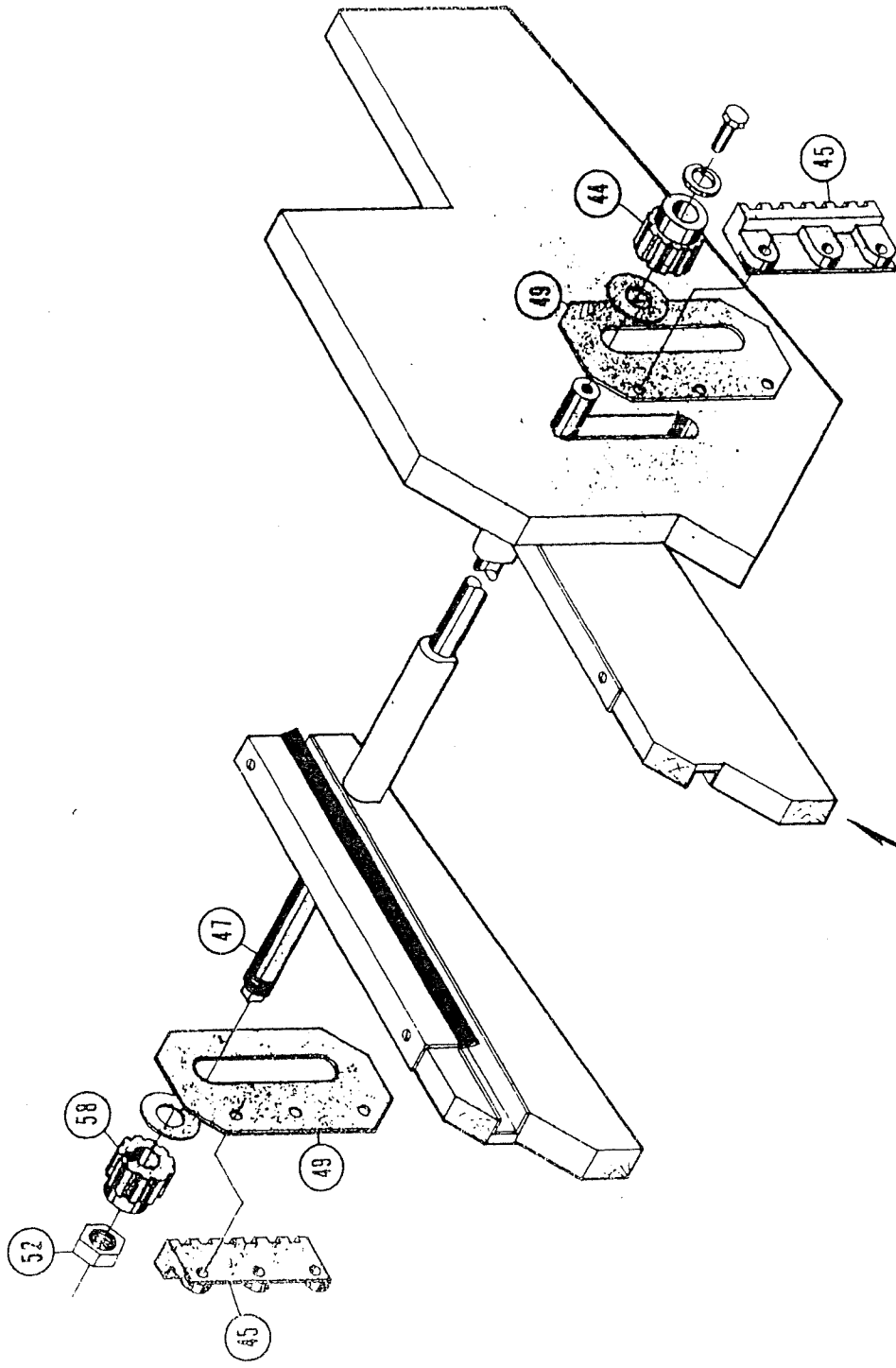

TILTING ROD ASSEMBLY

SYN		REVISION		DATE	DR	DWG. BY		SCALE	DATE	FERRELL - ROSS SAGINAW, MICH.		MACH. NO.
										tilting rod assembly		DWG. NO.





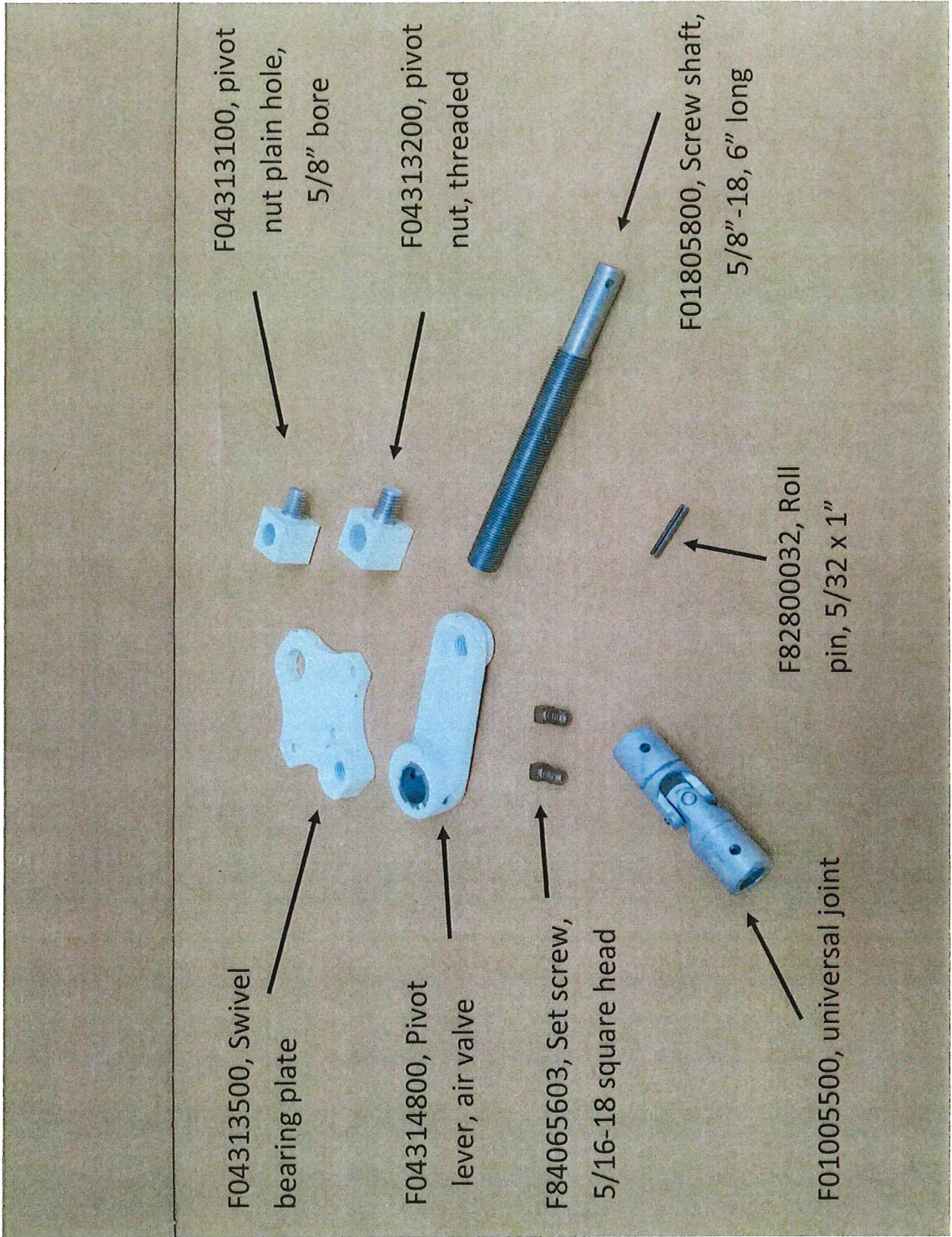

# F01013500, Gate valve adjusting assembly, ALL



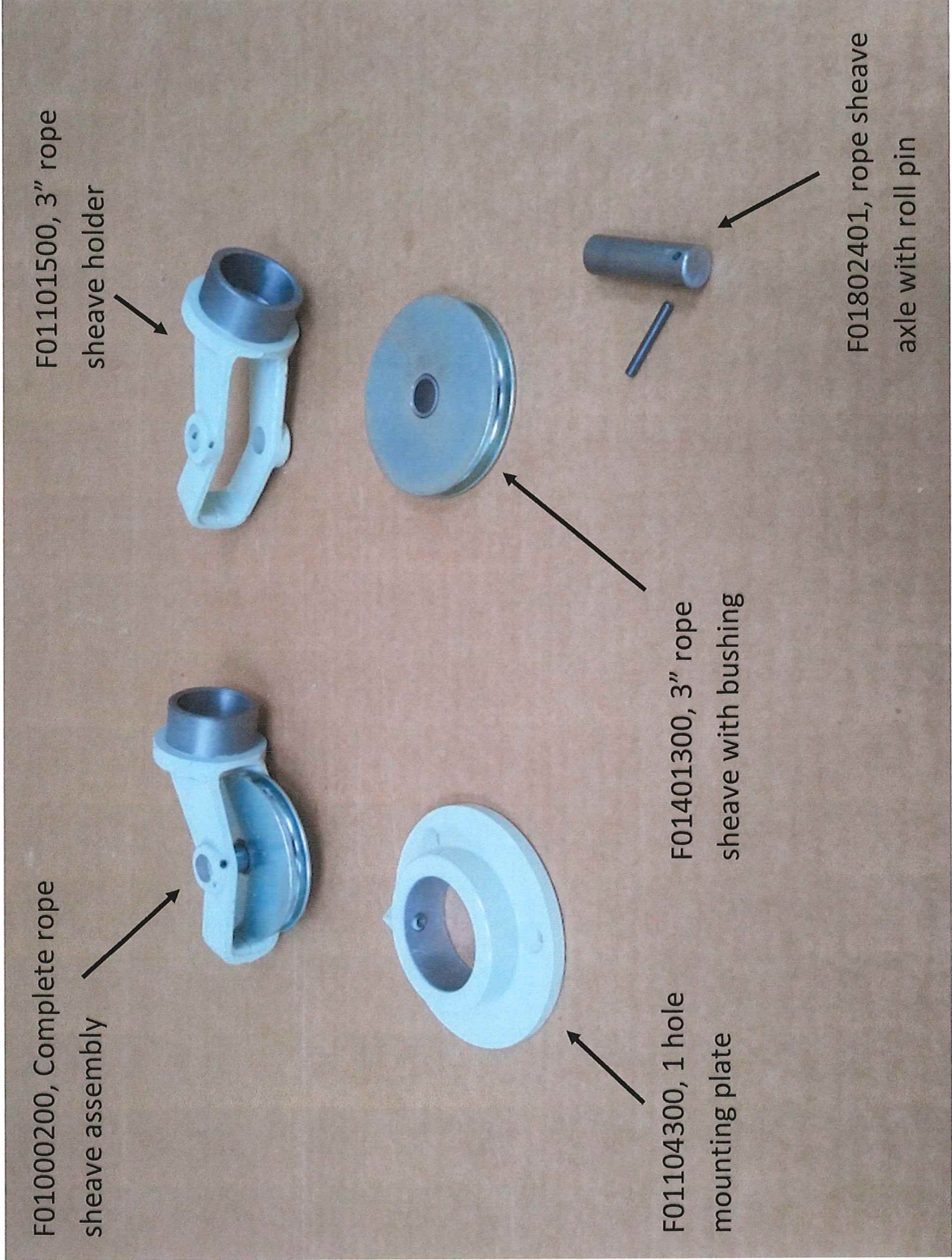

### 3" Rope sheave assembly



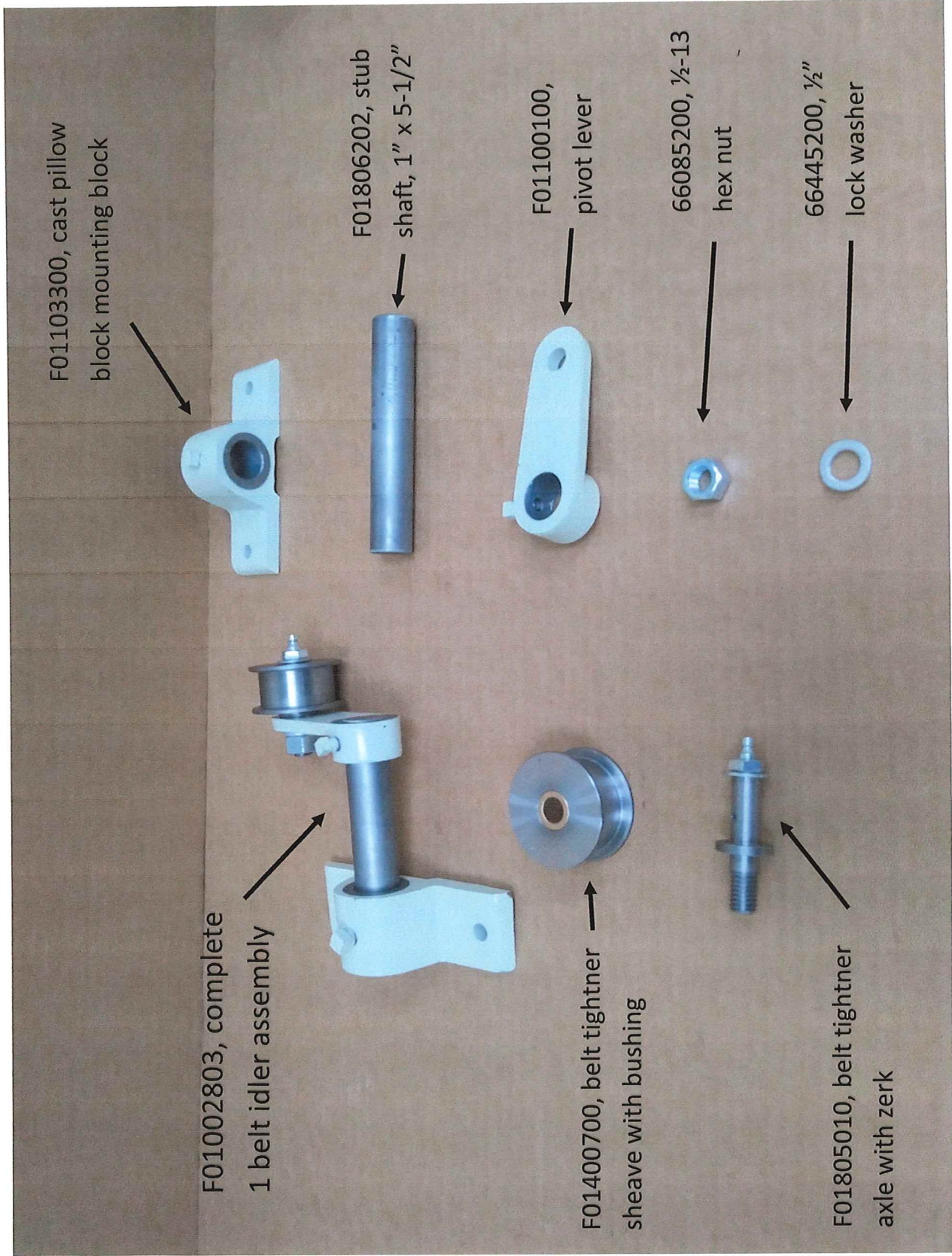

F01103300, cast pillow block mounting block

F01806202, stub shaft, 1" x 5-1/2"

F01100100, pivot lever

66085200, 1/2-13 hex nut

66445200, 1/2" lock washer

F01002803, complete 1 belt idler assembly

F01400700, belt tightener sheave with bushing

F01805010, belt tightener axle with zerck

## Belt tightener assembly



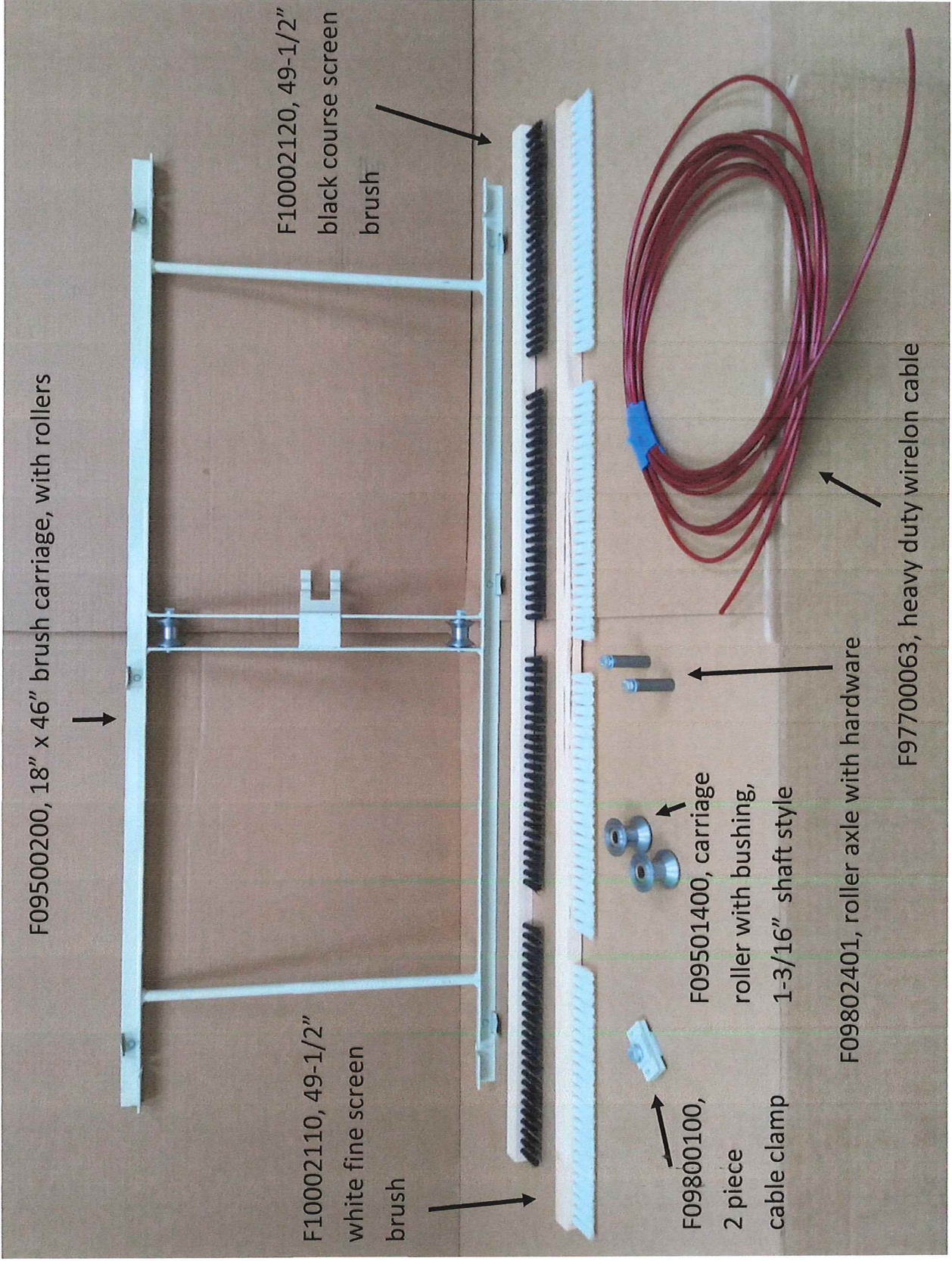

Brush carriage, with accessories, page 10



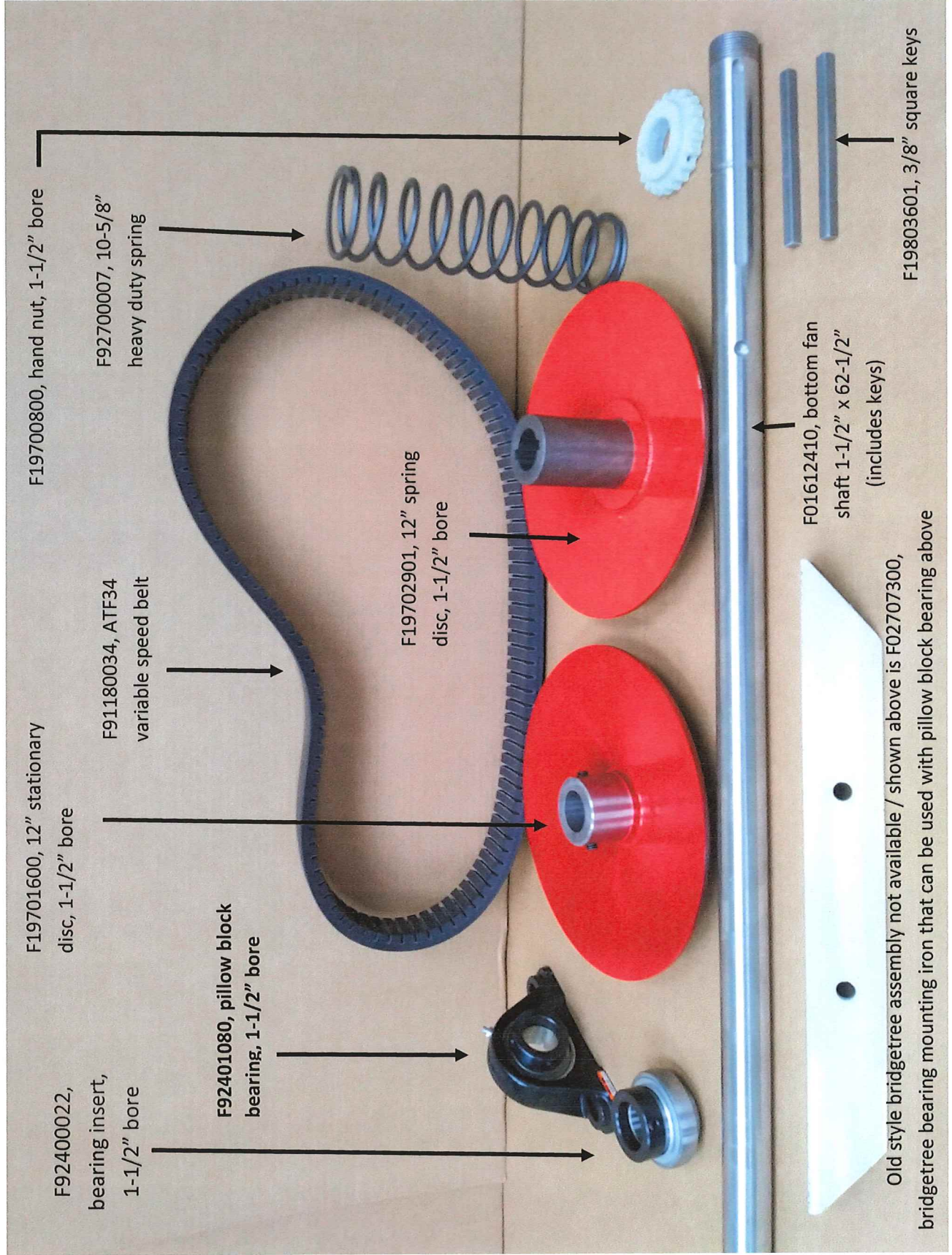

# Bottom fan shaft assembly, page 11



F06002679, complete bottom fan assembly

3 pieces, F06001000, bottom fan spider, 1-1/2" bore

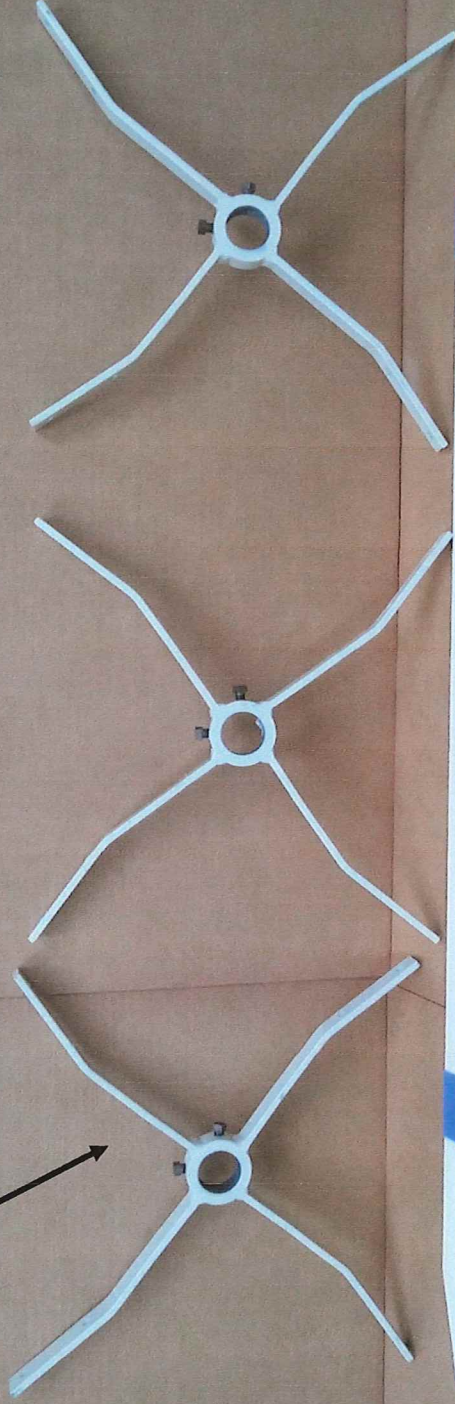
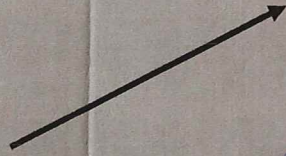

4 pieces, F01701100, bottom fan blade, 43-5/8" long



24 pieces, F82021407, elevator bolt, 1/4-20 x 1-1/4"

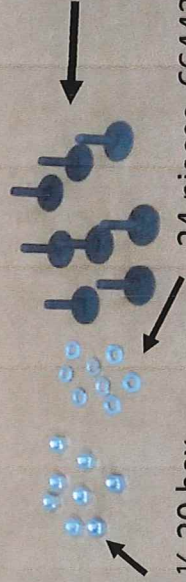

24 pieces, 66443300, 1/4" lock washer

24 pieces, 66083300, 1/4-20 hex

bottom fan assembly, 1-1/2" bore, 9 wide, page 12



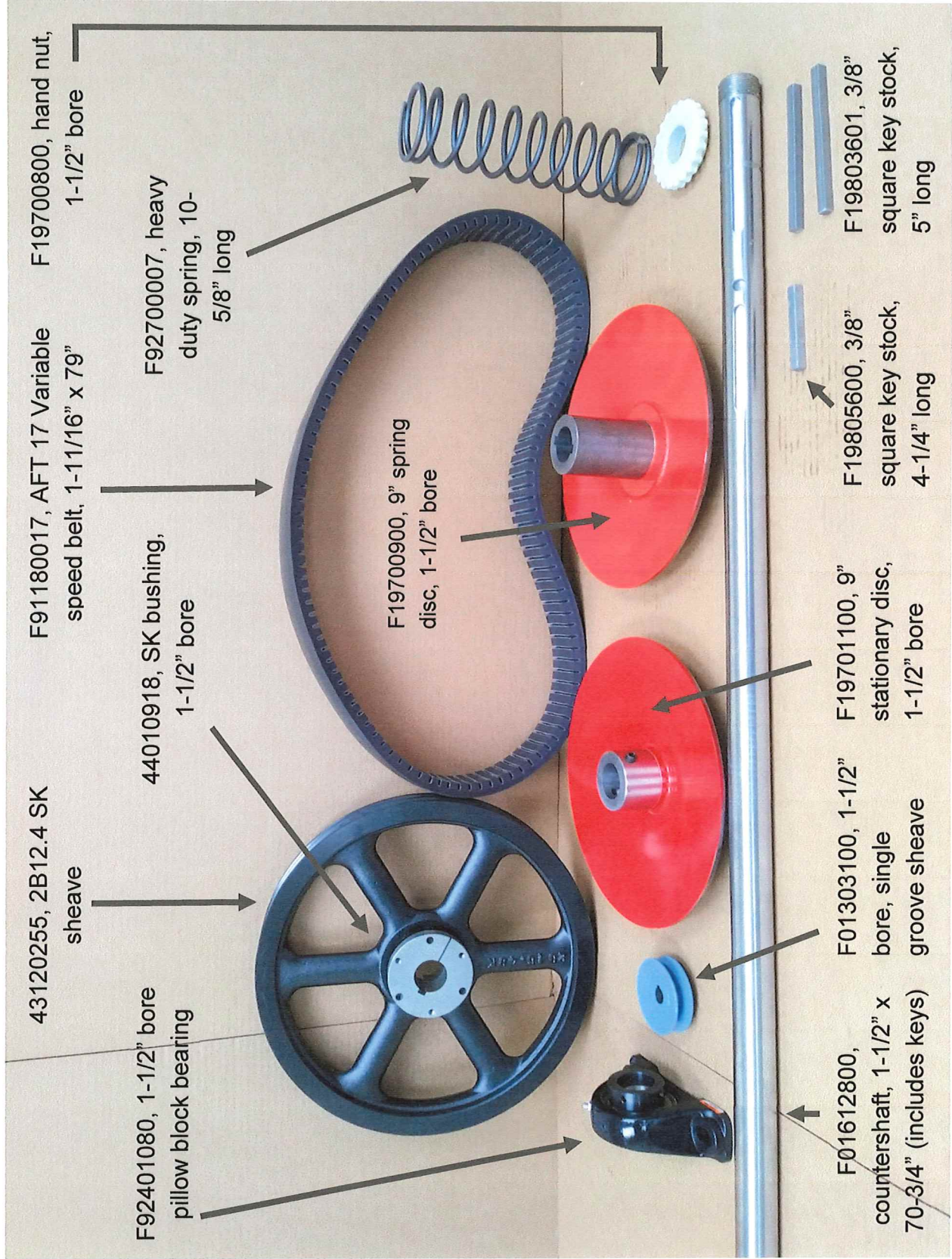

# Countershaft assembly, page 13



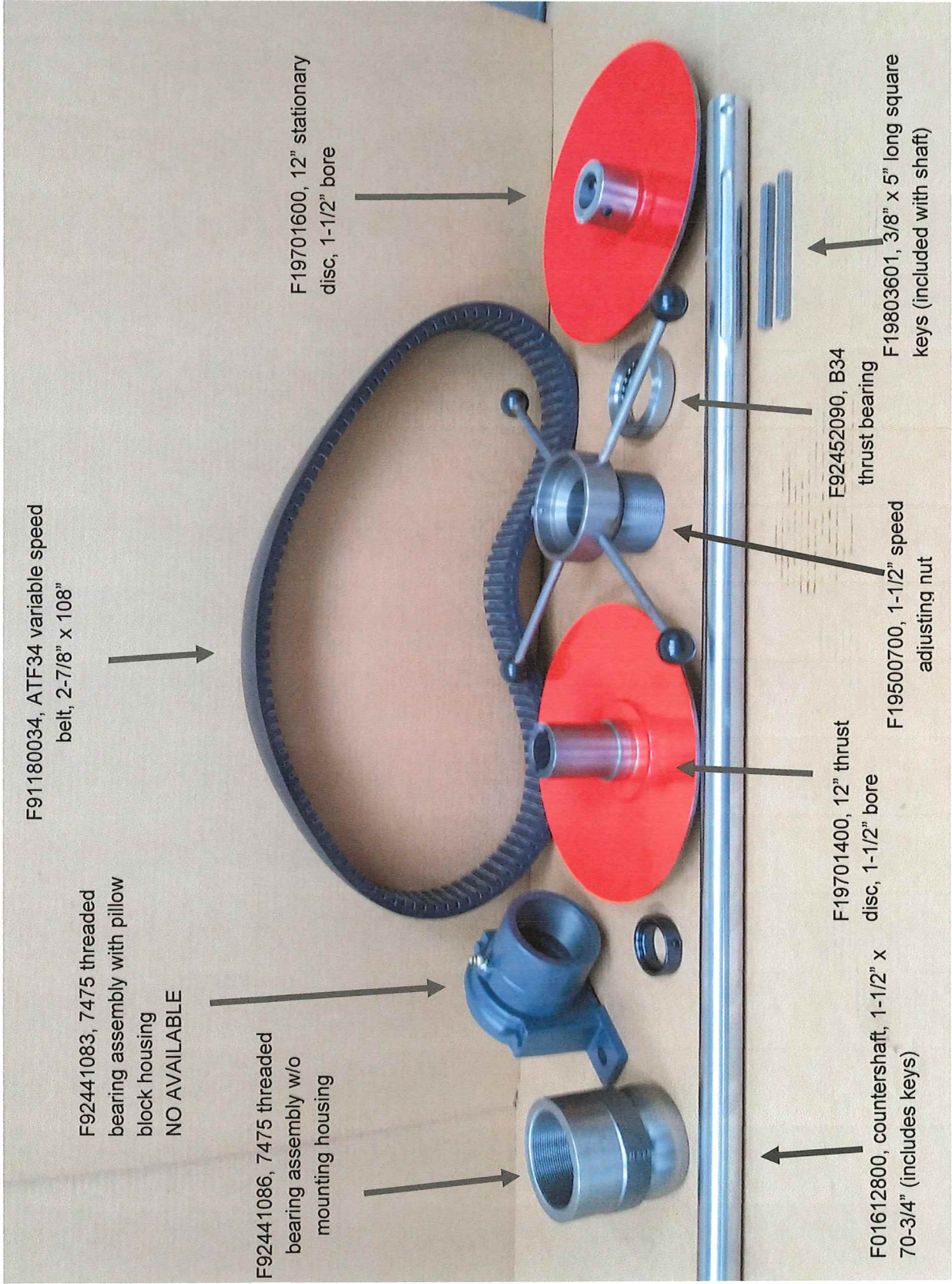

# Countershaft assembly page 14



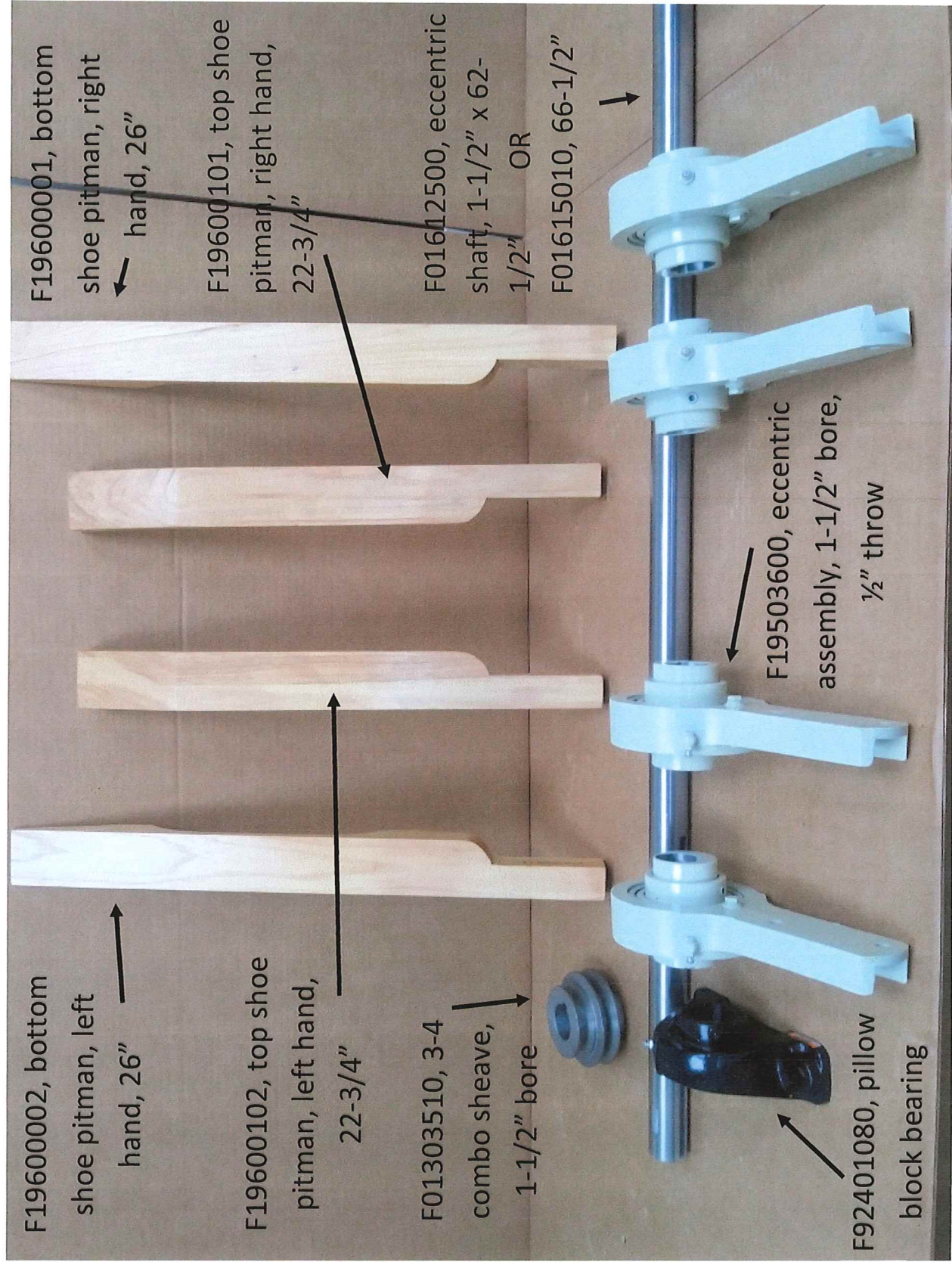

F19600001, bottom shoe pitman, right hand, 26"

F19600101, top shoe pitman, right hand, 22-3/4"

F01612500, eccentric shaft, 1-1/2" x 62-1/2" OR F01615010, 66-1/2"

F19600002, bottom shoe pitman, left hand, 26"

F19600102, top shoe pitman, left hand, 22-3/4"

F01303510, 3-4 combo sheave, 1-1/2" bore

F19503600, eccentric assembly, 1-1/2" bore, 1/2" throw

F92401080, pillow block bearing

Eccentric shaft assembly, Super 29D, page 15



F19503600, Complete eccentric assembly, 1-1/2" bore, 1/2" throw

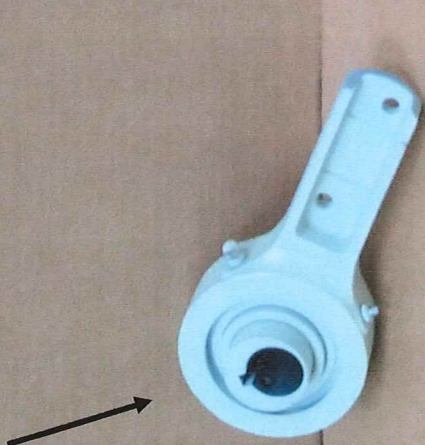

F19703000, Eccentric housing

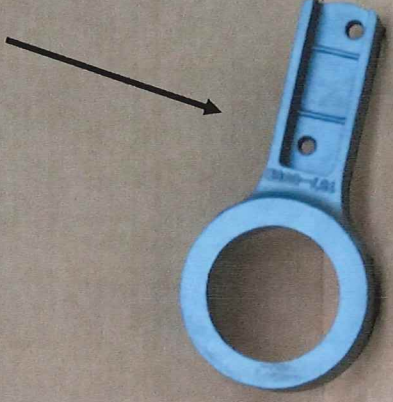

F92400053, Bearing insert



F19804004, Eccentric hub, 1-1/2" bore, 1/2" throw





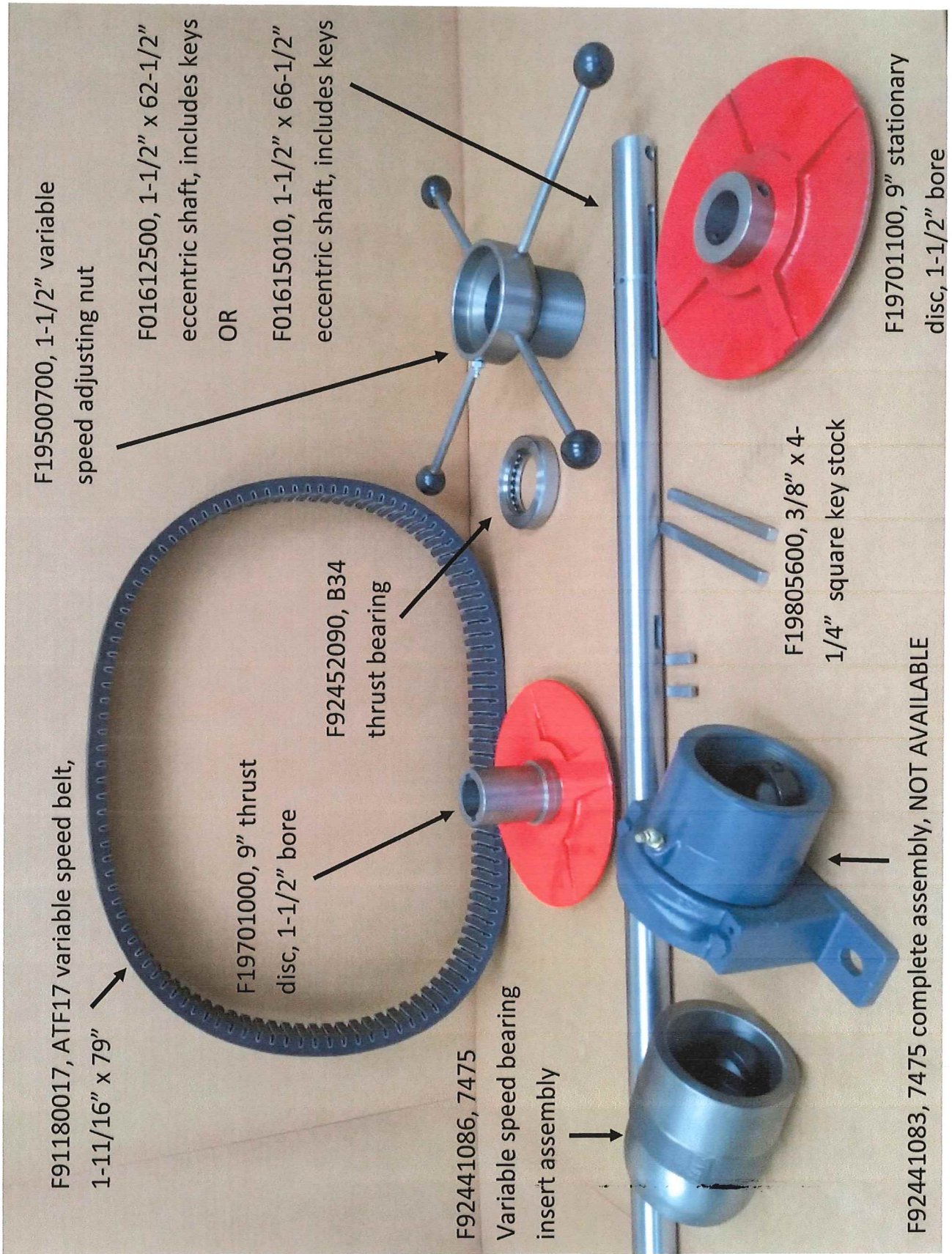

F19500700, 1-1/2" variable speed adjusting nut

F01612500, 1-1/2" x 62-1/2" eccentric shaft, includes keys  
OR  
F01615010, 1-1/2" x 66-1/2" eccentric shaft, includes keys

F91180017, ATF17 variable speed belt, 1-11/16" x 79"

F19701000, 9" thrust disc, 1-1/2" bore

F92452090, B34 thrust bearing

F92441086, 7475 Variable speed bearing insert assembly

F92441083, 7475 complete assembly, NOT AVAILABLE

F19805600, 3/8" x 4-1/4" square key stock

F19701100, 9" stationary disc, 1-1/2" bore

**Eccentric shaft assembly, 9" discs, Super 29D, page 16**





REV	BY	DATE	APPROVED
A	WJ	3/20/2013	RH
B	WJ	3/25/2013	gmbushon

REV	DESCRIPTION
A	RELEASE PRINTING
B	RELEASE PRINTING WAS GROUP DRAWING

REVISION HISTORY

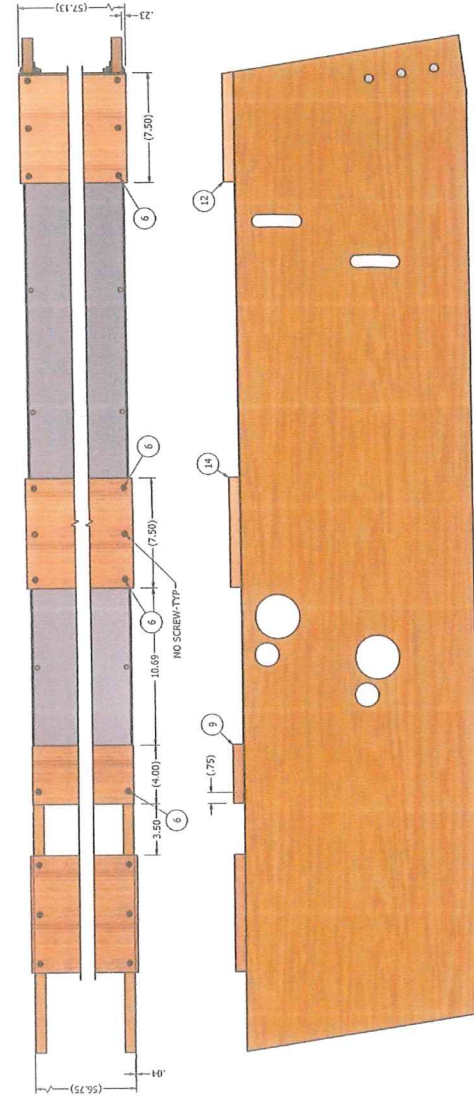

STEP 1: ISOMETRIC VIEW, UPSIDE DOWN  
BOTTOM CROSS BOARD INSTALLATION

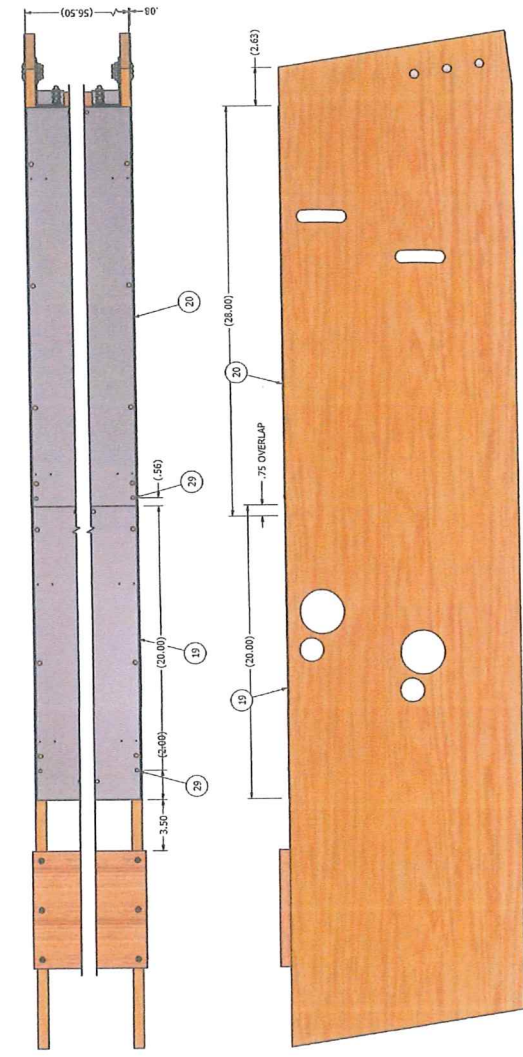

STEP 2: RIGHT SIDE VIEW, UPSIDE DOWN  
SHOE BOTTOM METAL INSTALLATION

ITEM	PART NUMBER	QTY	DESCRIPTION
32	FE8453402	106	SMS, PAN X HD, 48 X 3/4"
31	FE8440304	12	SMS, FLAT CROSS HEAD #10 X 2.50"
30	FE8440302	6	SMS, FLAT CROSS HEAD #10 X 1.75"
29	FE8400002	4	NAIL, 1 1/2 GA, 3/4" THICK, 7/16" HD 1346SS
28	F70000004	2	BRACKET, CROSS BOARD 6.00"
27	F13002217	2	SPOUT, LH DIVIDER SAND, 29
26			
25			
24			
23			
22			
21			
20			
19			
18	FD3300000	2	END IRON, BOTTOM SHOE, 290/290D
17	FD3300100	2	END IRON, REAR, TOP SHOE, 290/290D
16	FD3152002	1	BOARD, FRONT GRASS TOP SHOE, SCS9
15			
14			
13			
12			
11			
10	FD3100700	2	NUMBER, TOP SHOE, 290/290D
9	FE8100400	1	BOARD, CROSS BOARD SPOUT #4, SCS9
8	FD3100301	2	BOARD, CROSS BOARD SPOUT #2, SCS9
7	FD3100201	2	SIDE SHOE, TOP, 290/290D
6	700103241	26	SCW, DECK FLT, HD # 6 X 2.00"
5	667453000	12	NUT, HEX, SERLS LOCK, 1/4-20
4	668352208	7	NUT, WING 1/4-20 TYPE B STYLE 1
3	668352208	8	SMS, FLT X HD # 8 X 1.25"
2	668352208	13	SCW, DECK FLT, HD # 6 X 2.00"
1	668352208	13	SCW, DECK FLT, HD # 6 X 2.00"

 This drawing is the property of Furni A. Furni Company, Inc.  
 14100 E. 10th Avenue, Suite 100  
 Ellettsville, Indiana 47424  
 All rights reserved. No part of this drawing may be reproduced, stored in a retrieval system, or transmitted in any form or by any means, electronic, mechanical, photocopying, recording, or by any information storage and retrieval system, without prior written consent of Furni A. Furni Company, Inc.  
 PROJECT NUMBER: 721527013  
 DRAWING NUMBER: 721527013

TELEPHONE	FAX	TITLE	SHOE ASSY, TOP, 29 D
317-738-1111	317-738-1112	DESIGNER	WJ
		CHECKED	WJ
		APPROVED	RH
		DATE	3/25/2013

CAD CHANGES	REV	DATE	DESCRIPTION
	1		
	2		
	3		
	4		
	5		

NOTES:  
 1. DO NOT SCALE FROM DRAWING.  
 2. ONE PIECE REQUIRED PER FD3000004; SHOE ASSY, TOP W/ ROGGEERS, 29SD.











REV.	SCN	DESCRIPTION	DATE	APPROVED
A	01	REWORK CAD, WAS C-SIZE GROUP DRAWING, P13143201 & P13143202	3/27/2013	RM
B	02	REWORK CAD, WAS C-SIZE GROUP DRAWING, P13143201 & P13143202 & P13143203 & P13143204, ADD P13143205	3/27/2013	RM

REVISION HISTORY

DESCRIPTION

DATE

APPROVED

RM

3/27/2013

RM

3/27/2013

RM

3/27/2013

RM

3/27/2013

RM

3/27/2013

RM



DETAIL E  
SCALE 1/2



DETAIL F  
SCALE 1/2



DETAIL G  
SCALE 1/2



DETAIL H  
SCALE 1/2

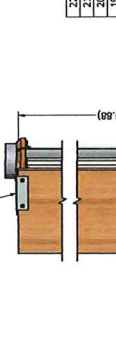

DETAIL I  
SCALE 1/2

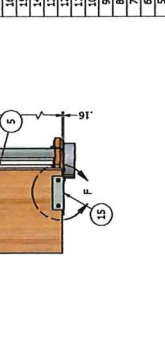

DETAIL J  
SCALE 1/2



DETAIL K  
SCALE 1/2

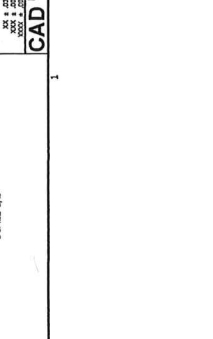

DETAIL L  
SCALE 1/2

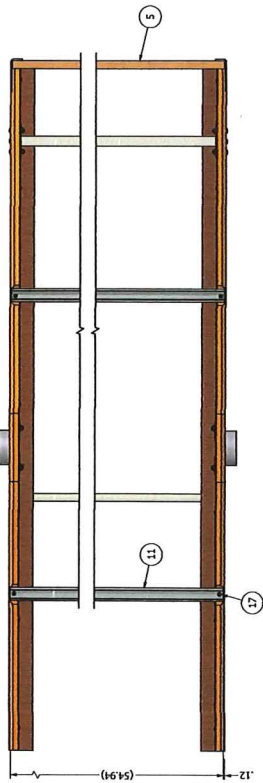

STEP 1: GIRTS INSTALLATION, TOP VIEW

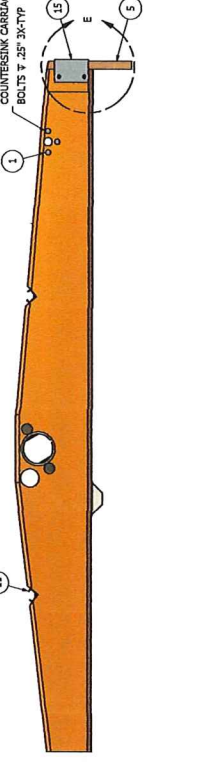

STEP 2: GIRTS INSTALLATION, TOP VIEW

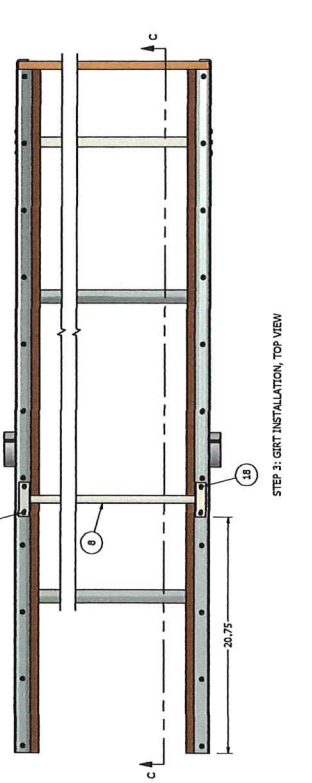

SECTION C-C



SECTION D-D

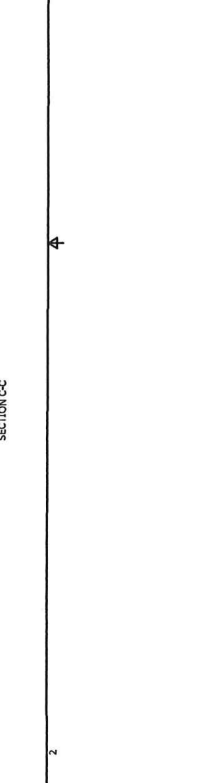

SECTION E-E



STEP 3: GIRTS INSTALLATION, TOP VIEW

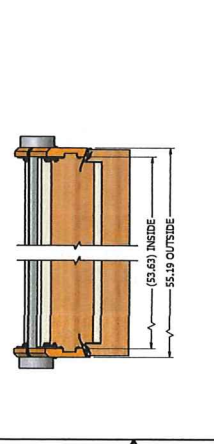

STEP 4: GIRTS INSTALLATION, TOP VIEW



STEP 5: GIRTS INSTALLATION, TOP VIEW



STEP 6: GIRTS INSTALLATION, TOP VIEW

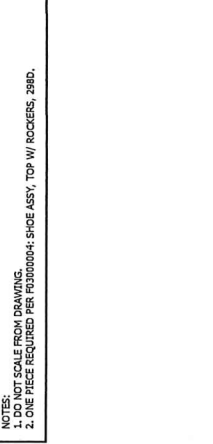

STEP 7: GIRTS INSTALLATION, TOP VIEW



STEP 8: GIRTS INSTALLATION, TOP VIEW



STEP 9: GIRTS INSTALLATION, TOP VIEW



STEP 10: GIRTS INSTALLATION, TOP VIEW



STEP 11: GIRTS INSTALLATION, TOP VIEW



STEP 12: GIRTS INSTALLATION, TOP VIEW



STEP 13: GIRTS INSTALLATION, TOP VIEW



STEP 14: GIRTS INSTALLATION, TOP VIEW















REV	EN	DESCRIPTION	DATE	APPROVED	INVEST
A	E130043	RELEASE	4/2/2013	JIMSE	

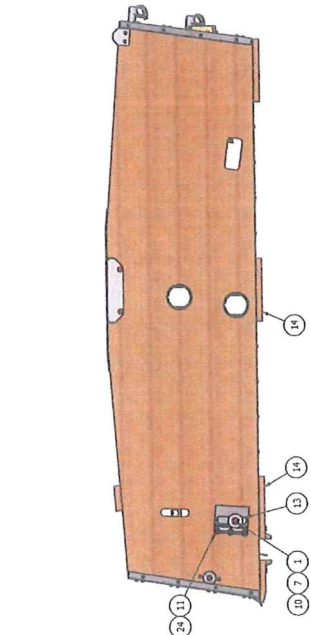

STEP 1: LEFT SIDE VIEW, LOWER ROCKER INSTALLATION

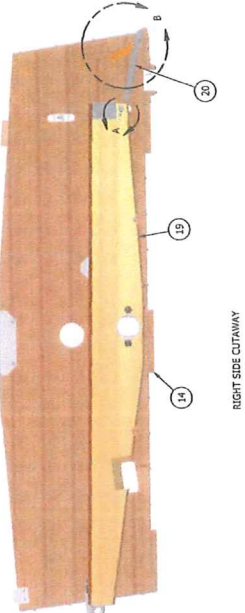

RIGHT SIDE CUTAWAY

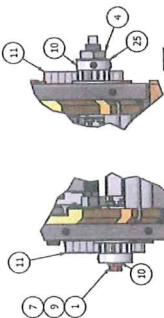

DETAIL C  
SCALE 1/3

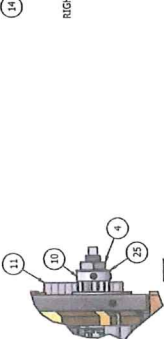

DETAIL D  
SCALE 1/3

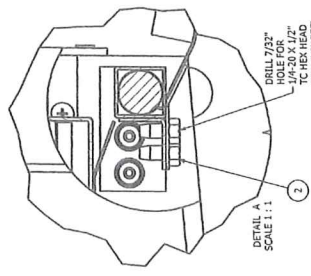

DETAIL A  
SCALE 1:1

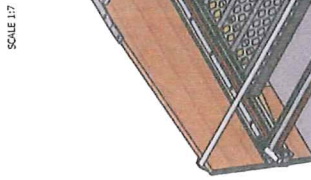

SCALE 1:7

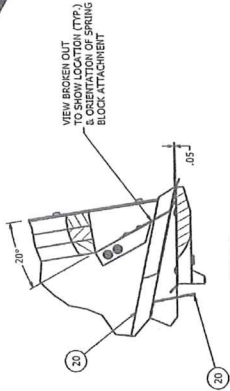

DETAIL B  
SCALE 1/3

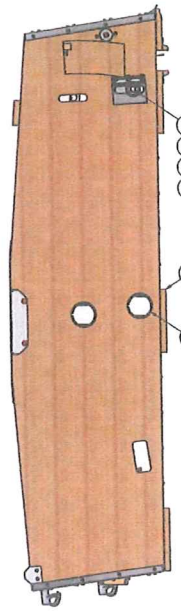

STEP 1: RIGHT SIDE VIEW, LOWER ROCKER INSTALLATION

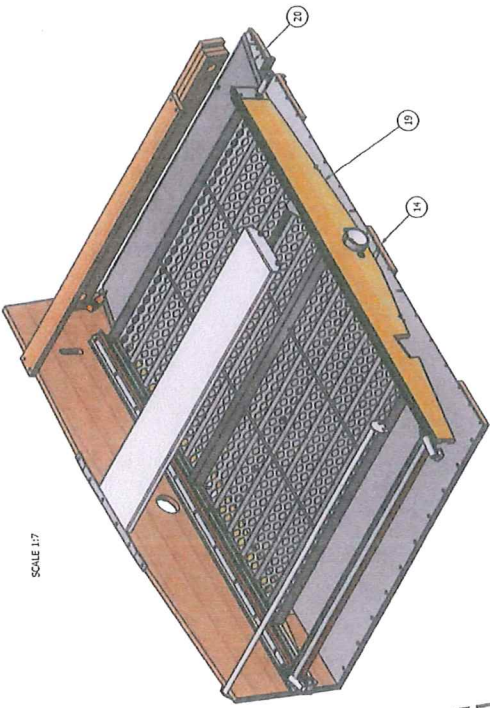

ITEM #	PART NUMBER	QTY	DESCRIPTION
27	F9000659	2	BALL TRAY WIDTH 65.55 GREEN #9
28	F9000659	2	BALL TRAY WIDTH 65.55 GREEN #9
29	F9000659	2	WASHER - FLT 250 X 1.250 X .062
30	F83548103	12	SMS. PAN X HD. 48 X 1"
31	F8307440	2	STUD DOVREL 1/4-20 X 2.50"
32	F06030501	1	SPOUT. SAND RH. 290
33	F06030501	1	SPOUT. SAND RH. 290
34	F06030501	1	SPOUT. SAND RH. 290
35	F06030501	1	SPOUT. SAND RH. 290
36	F06030501	1	SPOUT. SAND RH. 290
37	F03401600	1	APRON ASSY. 1.25 X 40.50" SEED #9
38	F03000276	1	APRON SPRING ASSY-RH
39	F03000276	1	APRON SPRING ASSY-LH
40	F03000118	1	PLATE ESCUTCHION, TILT ROD ROCKER
41	F01608332	2	SHAFT. ROCKER. TILT. 7.5 X 48.5" #9
42	F01200200	4	BACK STRAIGHT ROCKER ADJUSTING
43	F01200200	4	PISTON. BRUSH. ADJ. 13 TOOTH W/SET SCREWS
44	F01200200	4	PISTON. BRUSH. ADJ. 13 TOOTH W/SET SCREWS
45	F01200200	4	PISTON. BRUSH. ADJ. 13 TOOTH W/SET SCREWS
46	F01200200	4	PISTON. BRUSH. ADJ. 13 TOOTH W/SET SCREWS
47	F01200200	4	PISTON. BRUSH. ADJ. 13 TOOTH W/SET SCREWS
48	F01200200	4	PISTON. BRUSH. ADJ. 13 TOOTH W/SET SCREWS
49	F01200200	4	PISTON. BRUSH. ADJ. 13 TOOTH W/SET SCREWS
50	F01200200	4	PISTON. BRUSH. ADJ. 13 TOOTH W/SET SCREWS
51	F01200200	4	PISTON. BRUSH. ADJ. 13 TOOTH W/SET SCREWS
52	F01200200	4	PISTON. BRUSH. ADJ. 13 TOOTH W/SET SCREWS
53	F01200200	4	PISTON. BRUSH. ADJ. 13 TOOTH W/SET SCREWS
54	F01200200	4	PISTON. BRUSH. ADJ. 13 TOOTH W/SET SCREWS
55	F01200200	4	PISTON. BRUSH. ADJ. 13 TOOTH W/SET SCREWS
56	F01200200	4	PISTON. BRUSH. ADJ. 13 TOOTH W/SET SCREWS
57	F01200200	4	PISTON. BRUSH. ADJ. 13 TOOTH W/SET SCREWS
58	F01200200	4	PISTON. BRUSH. ADJ. 13 TOOTH W/SET SCREWS
59	F01200200	4	PISTON. BRUSH. ADJ. 13 TOOTH W/SET SCREWS
60	F01200200	4	PISTON. BRUSH. ADJ. 13 TOOTH W/SET SCREWS
61	F01200200	4	PISTON. BRUSH. ADJ. 13 TOOTH W/SET SCREWS
62	F01200200	4	PISTON. BRUSH. ADJ. 13 TOOTH W/SET SCREWS
63	F01200200	4	PISTON. BRUSH. ADJ. 13 TOOTH W/SET SCREWS
64	F01200200	4	PISTON. BRUSH. ADJ. 13 TOOTH W/SET SCREWS
65	F01200200	4	PISTON. BRUSH. ADJ. 13 TOOTH W/SET SCREWS
66	F01200200	4	PISTON. BRUSH. ADJ. 13 TOOTH W/SET SCREWS
67	F01200200	4	PISTON. BRUSH. ADJ. 13 TOOTH W/SET SCREWS
68	F01200200	4	PISTON. BRUSH. ADJ. 13 TOOTH W/SET SCREWS
69	F01200200	4	PISTON. BRUSH. ADJ. 13 TOOTH W/SET SCREWS
70	F01200200	4	PISTON. BRUSH. ADJ. 13 TOOTH W/SET SCREWS
71	F01200200	4	PISTON. BRUSH. ADJ. 13 TOOTH W/SET SCREWS
72	F01200200	4	PISTON. BRUSH. ADJ. 13 TOOTH W/SET SCREWS
73	F01200200	4	PISTON. BRUSH. ADJ. 13 TOOTH W/SET SCREWS
74	F01200200	4	PISTON. BRUSH. ADJ. 13 TOOTH W/SET SCREWS
75	F01200200	4	PISTON. BRUSH. ADJ. 13 TOOTH W/SET SCREWS
76	F01200200	4	PISTON. BRUSH. ADJ. 13 TOOTH W/SET SCREWS
77	F01200200	4	PISTON. BRUSH. ADJ. 13 TOOTH W/SET SCREWS
78	F01200200	4	PISTON. BRUSH. ADJ. 13 TOOTH W/SET SCREWS
79	F01200200	4	PISTON. BRUSH. ADJ. 13 TOOTH W/SET SCREWS
80	F01200200	4	PISTON. BRUSH. ADJ. 13 TOOTH W/SET SCREWS
81	F01200200	4	PISTON. BRUSH. ADJ. 13 TOOTH W/SET SCREWS
82	F01200200	4	PISTON. BRUSH. ADJ. 13 TOOTH W/SET SCREWS
83	F01200200	4	PISTON. BRUSH. ADJ. 13 TOOTH W/SET SCREWS
84	F01200200	4	PISTON. BRUSH. ADJ. 13 TOOTH W/SET SCREWS
85	F01200200	4	PISTON. BRUSH. ADJ. 13 TOOTH W/SET SCREWS
86	F01200200	4	PISTON. BRUSH. ADJ. 13 TOOTH W/SET SCREWS
87	F01200200	4	PISTON. BRUSH. ADJ. 13 TOOTH W/SET SCREWS
88	F01200200	4	PISTON. BRUSH. ADJ. 13 TOOTH W/SET SCREWS
89	F01200200	4	PISTON. BRUSH. ADJ. 13 TOOTH W/SET SCREWS
90	F01200200	4	PISTON. BRUSH. ADJ. 13 TOOTH W/SET SCREWS
91	F01200200	4	PISTON. BRUSH. ADJ. 13 TOOTH W/SET SCREWS
92	F01200200	4	PISTON. BRUSH. ADJ. 13 TOOTH W/SET SCREWS
93	F01200200	4	PISTON. BRUSH. ADJ. 13 TOOTH W/SET SCREWS
94	F01200200	4	PISTON. BRUSH. ADJ. 13 TOOTH W/SET SCREWS
95	F01200200	4	PISTON. BRUSH. ADJ. 13 TOOTH W/SET SCREWS
96	F01200200	4	PISTON. BRUSH. ADJ. 13 TOOTH W/SET SCREWS
97	F01200200	4	PISTON. BRUSH. ADJ. 13 TOOTH W/SET SCREWS
98	F01200200	4	PISTON. BRUSH. ADJ. 13 TOOTH W/SET SCREWS
99	F01200200	4	PISTON. BRUSH. ADJ. 13 TOOTH W/SET SCREWS
100	F01200200	4	PISTON. BRUSH. ADJ. 13 TOOTH W/SET SCREWS

This drawing is the property of F. A. T. Inc. and must be returned to the originator upon request. No part of this drawing is to be reproduced, stored in a retrieval system or transmitted in any form or by any means, electronic, mechanical, photocopying, recording, or otherwise, without the prior written consent of the F. A. T. Fernal Company, Inc.

**CAD**  
NO MANUAL CHANGES TO BE MADE TO THIS DRAWING.  
DATE: 4/2/2013  
DRAWN BY: JIMSE  
CHECKED BY: JIMSE  
APPROVED BY: JIMSE  
SCALE: 1:1  
PROJECT: 177  
JOB: JIMSE  
DWG: 010  
REV: 1  
REV DATE: 3/28/2013  
REV BY: JIMSE  
REV DESCRIPTION: SHOE ASSY, BOTTOM RH W/ROCKERS BALL TRAY, 290  
PART NUMBER: F90006116  
SHEET: 1 of 3





REV	BY	DATE	APPROVED
A	FJ10043	3/28/2013	jmoss
RELEASED			

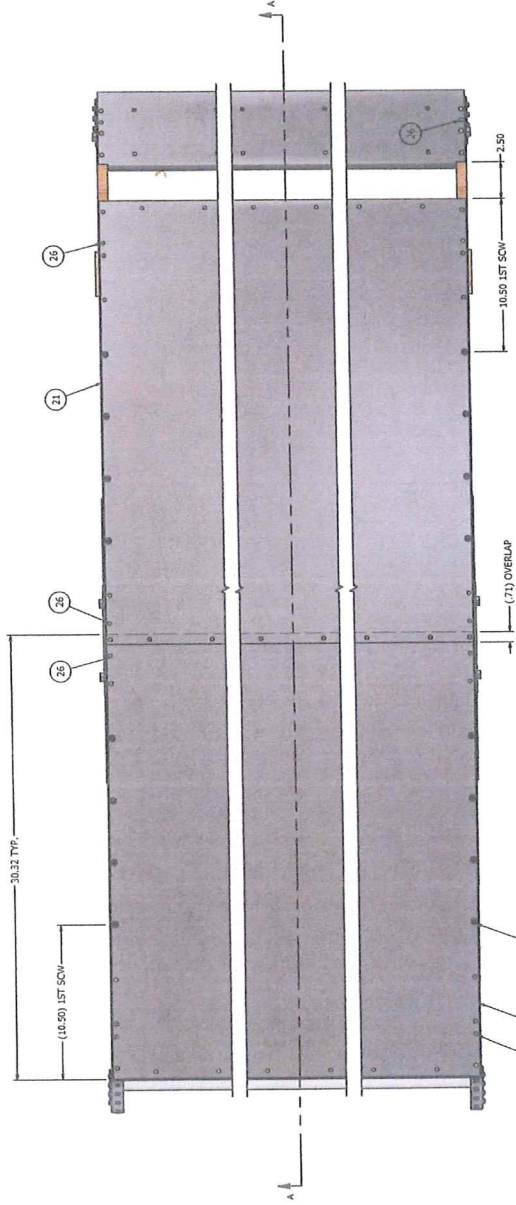

BOTTOM VIEW, STEP 2  
BOTTOM METAL INSTALLATION

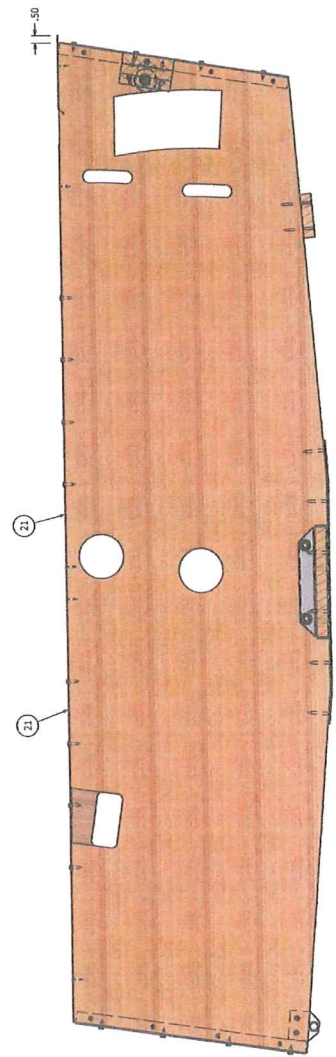

SECTION A-A  
SCALE 1/4

ITEM	QUANTITY	DESCRIPTION
31	4	SHIS, RLT X HD, #8 X 3/4"
30	62	SHIS, PANI X HD, #8 X 3/4"
29	32	SHIS, PANI X HD, #8 X 1/2"
28	2	SHIS, FLAT CROSS HEAD #10 X 1.75"
27	12	SHIS, FLAT CROSS HEAD #10 X 1.50"
26	2	SHIS, FLAT CROSS HEAD #10 X 1.50"
25	2	SHIS, FLAT CROSS HEAD #10 X 1.50"
24	2	SHIS, FLAT CROSS HEAD #10 X 1.50"
23	2	SHIS, FLAT CROSS HEAD #10 X 1.50"
22	2	SHIS, FLAT CROSS HEAD #10 X 1.50"
21	2	SHIS, FLAT CROSS HEAD #10 X 1.50"
20	2	SHIS, FLAT CROSS HEAD #10 X 1.50"
19	2	SHIS, FLAT CROSS HEAD #10 X 1.50"
18	2	SHIS, FLAT CROSS HEAD #10 X 1.50"
17	2	SHIS, FLAT CROSS HEAD #10 X 1.50"
16	2	SHIS, FLAT CROSS HEAD #10 X 1.50"
15	2	SHIS, FLAT CROSS HEAD #10 X 1.50"
14	2	SHIS, FLAT CROSS HEAD #10 X 1.50"
13	2	SHIS, FLAT CROSS HEAD #10 X 1.50"
12	2	SHIS, FLAT CROSS HEAD #10 X 1.50"
11	2	SHIS, FLAT CROSS HEAD #10 X 1.50"
10	2	SHIS, FLAT CROSS HEAD #10 X 1.50"
9	2	SHIS, FLAT CROSS HEAD #10 X 1.50"
8	2	SHIS, FLAT CROSS HEAD #10 X 1.50"
7	2	SHIS, FLAT CROSS HEAD #10 X 1.50"
6	2	SHIS, FLAT CROSS HEAD #10 X 1.50"
5	2	SHIS, FLAT CROSS HEAD #10 X 1.50"
4	2	SHIS, FLAT CROSS HEAD #10 X 1.50"
3	2	SHIS, FLAT CROSS HEAD #10 X 1.50"
2	2	SHIS, FLAT CROSS HEAD #10 X 1.50"
1	2	SHIS, FLAT CROSS HEAD #10 X 1.50"

**A. FERRELL COMPANY**  
 DIVISION OF  
 BLUFFTON, INDIANA  
 1000 W. 10TH STREET  
 PH: 317-833-3400  
 FAX: 317-833-3400  
 WWW.AFERRELL.COM

This drawing is the property of A. Ferrell Company, Inc.  
 No part of this drawing may be reproduced, stored in a  
 retrieval system or transmitted in any form or by any means  
 electronic, mechanical, photocopying, recording, or by any  
 information storage and retrieval system without the written  
 permission of A. Ferrell Company, Inc.

TITLE: SHOE ASSY, BOTTOM RH, 29D  
 FUNCTIONAL: SHOE  
 DATE: 3/28/2013  
 DRAWN BY: JIMMOSS  
 CHECKED BY: JIMMOSS

**CAD CHANGES**    SCALE: 1:4    SHEET: 2 OF 6    PART NUMBER: F03060114    A

NOTES:  
 1. DO NOT SCALE FROM DRAWING.  
 2. ONE PC ROD PER PH: F03000108; BTH SHOE ASSY W/WORKS RH 29D.

















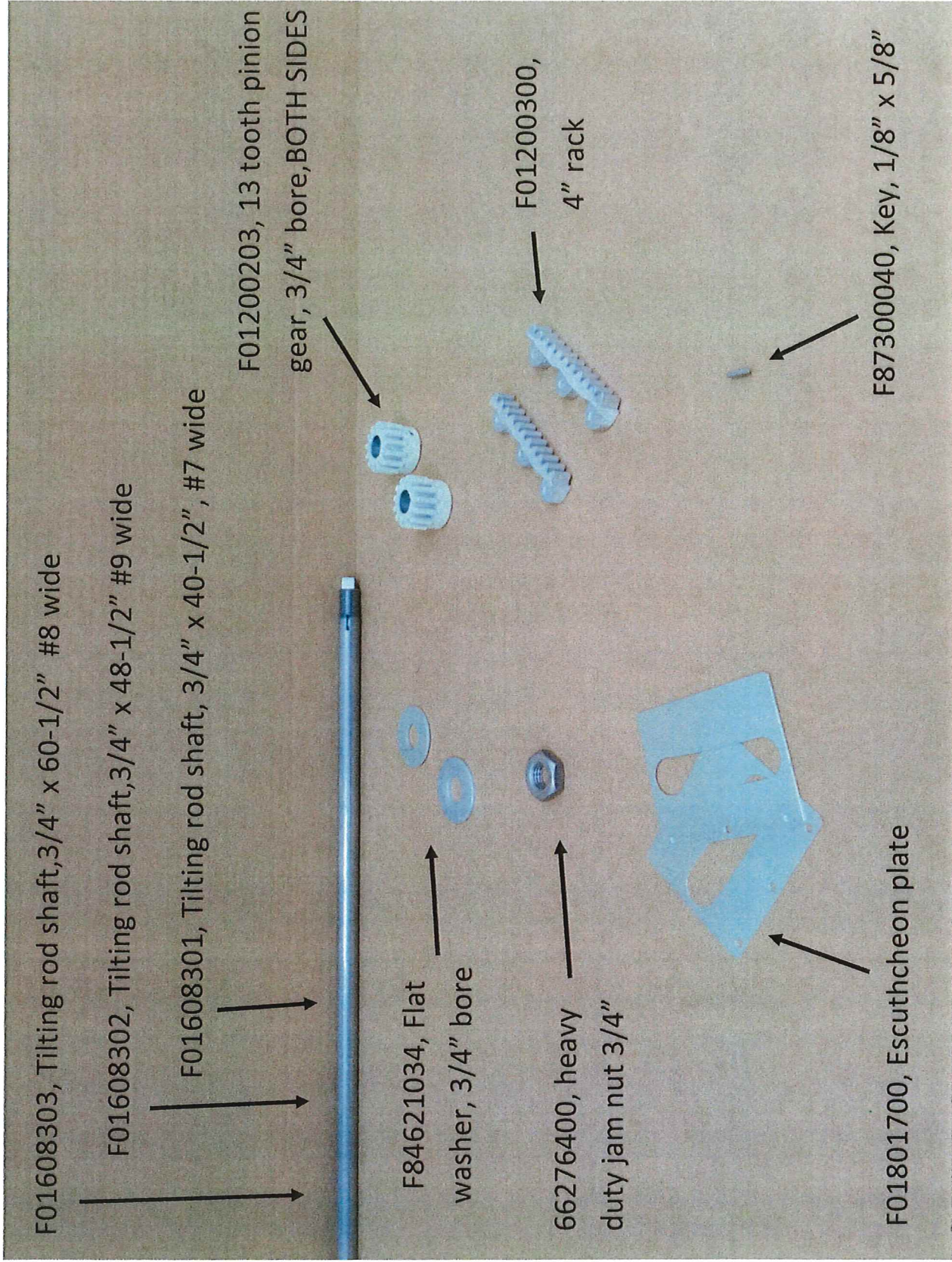

F01608303, Tilting rod shaft, 3/4" x 60-1/2" #8 wide

F01608302, Tilting rod shaft, 3/4" x 48-1/2" #9 wide

F01608301, Tilting rod shaft, 3/4" x 40-1/2", #7 wide

F01200203, 13 tooth pinion gear, 3/4" bore, BOTH SIDES

F84621034, Flat washer, 3/4" bore

66276400, heavy duty jam nut 3/4"

F01200300, 4" rack

F87300040, Key, 1/8" x 5/8"

F01801700, Escutcheon plate

# Screen rocker adjusting assembly





# Bottom Fan Metal

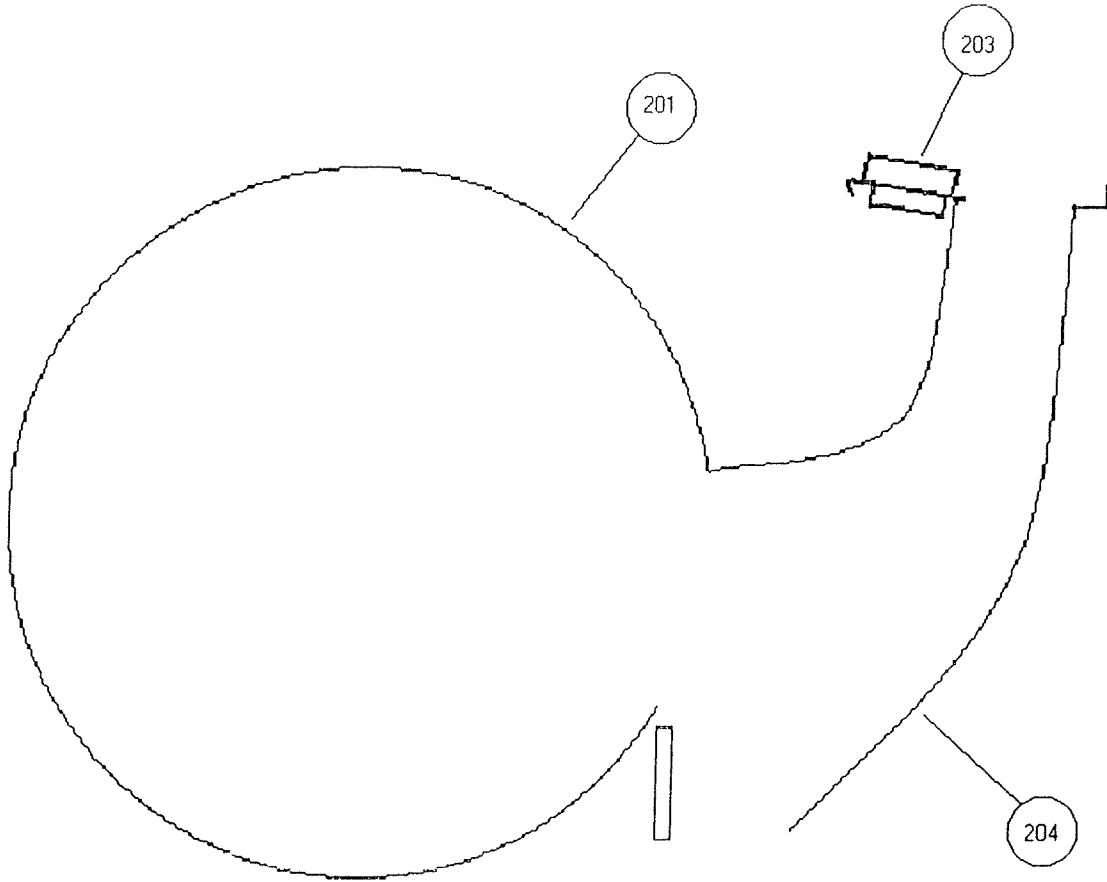

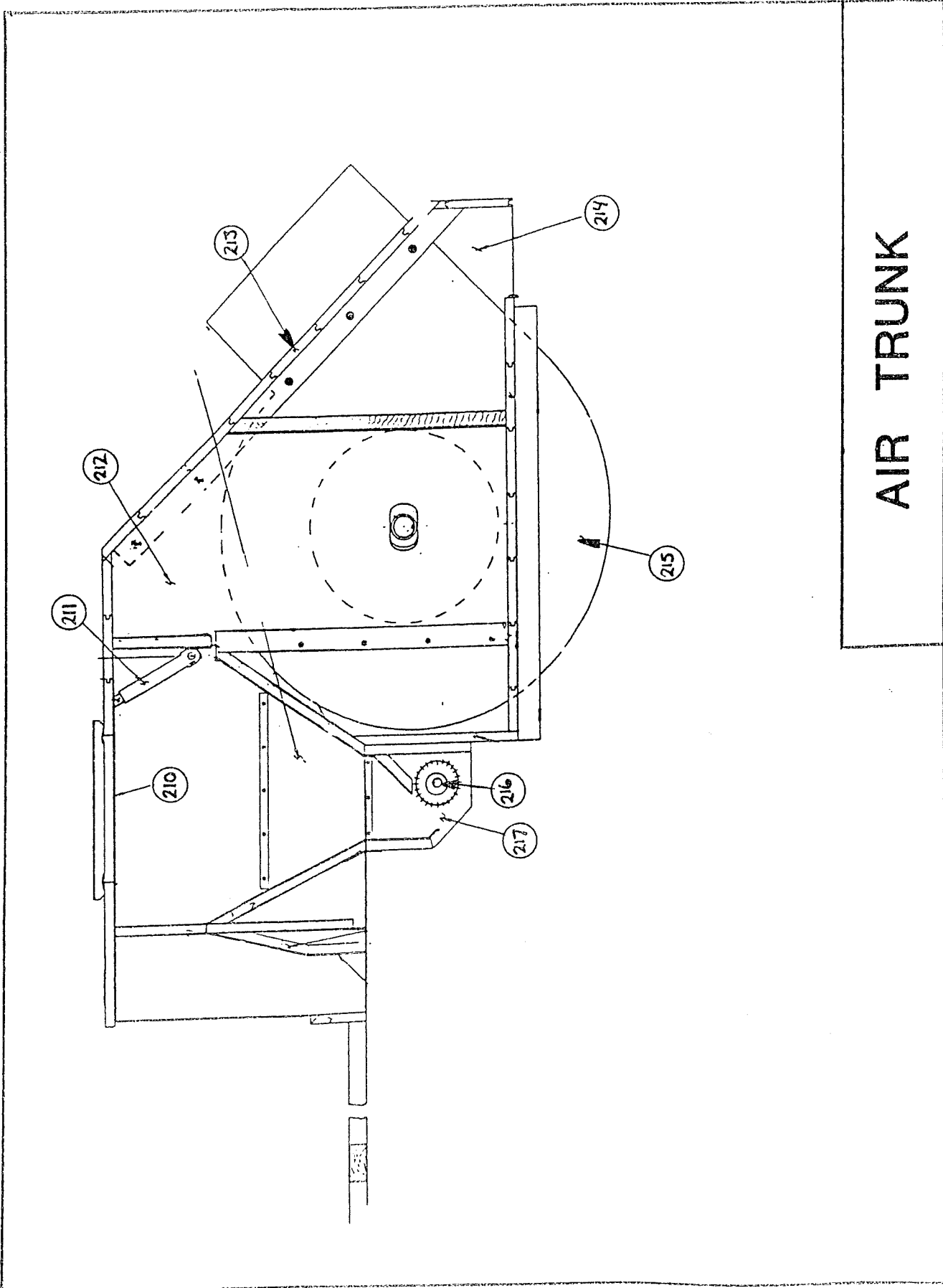

AIR TRUNK